

CAMP NEUSTADT AREA MAP

20079 CAMP NEUSTADT ROAD 120N.
GIMLI, MB, R0C 1B0

TO MORDENS MEADOWS

FROM HWY 222

CAMP NEUSTADT ROAD

NORTHLANDS

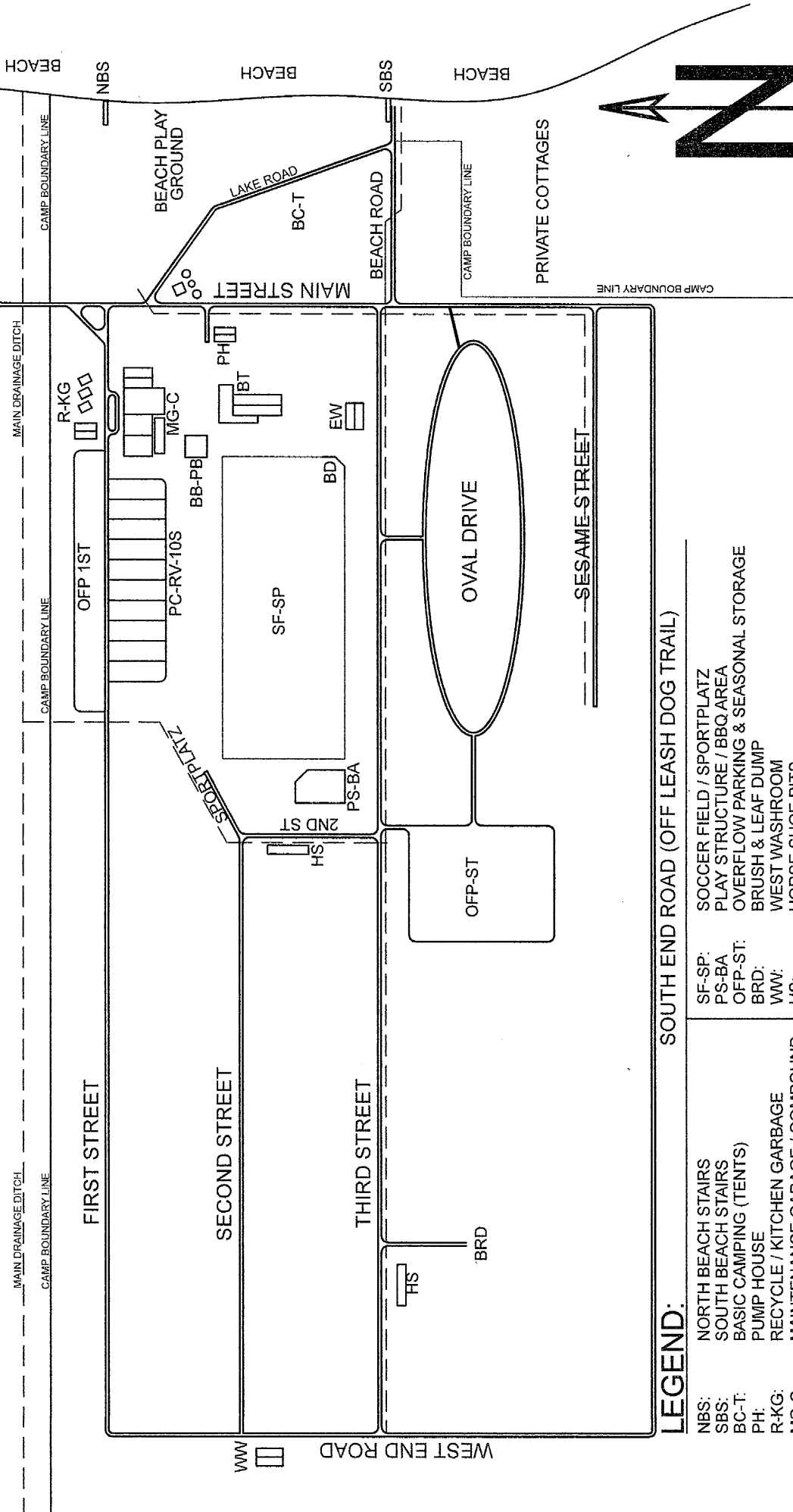

LEGEND:

- | | | | |
|------------|---------------------------------|-----------|-------------------------------------|
| NBS: | NORTH BEACH STAIRS | SF-SP: | SOCCER FIELD / SPORTPLATZ |
| SBS: | SOUTH BEACH STAIRS | PS-BA: | PLAY STRUCTURE / BBQ AREA |
| BC-T: | BASIC CAMPING (TENTS) | OFF-ST: | OVERFLOW PARKING & SEASONAL STORAGE |
| PH: | PUMP HOUSE | BRD: | BRUSH & LEAF DUMP |
| R-KG: | RECYCLE / KITCHEN GARBAGE | WW: | WEST WASHROOM |
| MG-C: | MAINTENANCE GARAGE / COMPOUND | HS: | HORSE SHOE PITS |
| BT: | BEER TENT | - - - - - | DRAINAGE DITCHES |
| EW: | EAST WASHROOM | | |
| BB-PB: | BASKETBALL / PICKLEBALL | | |
| BD: | BASEBALL DIAMOND | | |
| OFF-1ST: | OVERFLOW PARKING FIRST ST. | | |
| PC-RV-10S: | PREMIUM CAMPING - R.V. 10 SITES | | |

SOUTH END ROAD (OFF LEASH DOG TRAIL)

NTS - NOT TO SCALE